



# Elegant Eggs

Transform a wooden egg into a bejeweled beauty

by **Anna Nehs**

With these crystal beauties, putting all your eggs in one basket is good advice, and it's easy to follow using this netting technique. Perfect not only at Easter but at any time of year, their charm may have you scrambling to whip up a dozen or more.

## stepbystep

Prepare the wooden egg by coating it with acrylic paint if desired. I painted mine in black. Start with the row of largest crystals (middle), then use smaller crystals or pearls as you work toward each end. The first few rows are the most difficult since you have to hold the beads in place while stitching.

**[1]** Pick up three 11°s and

one 6mm crystal 14 times. Slide the beads to the middle of a 6-yd. (5.5m) length of Fireline and sew back through all the beads again to form a tight circle. Tie a surgeon's knot (Basics) to secure the circle. Roll the circle of beads carefully over the egg so it sits about a third of the way down from the top.

**[2]** Work toward the bottom of the egg. Make sure the

thread is exiting a middle 11° of any three 11°s on the row. Pick up seven 11°s and sew through the next middle 11° (**figure 1, a–b**). Repeat around the egg until you are back at **point a**. Sew through the first four 11°s added in this step (**b–c**).

**[3]** Pick up a 15°, a pearl, and a 15° (you can use a smaller pearl or crystal here, but you may have to fill in the gap with two 15°s instead of one). Sew through the next middle 11° (**c–d**). Repeat around the egg until you are back at **point c**.

**[4]** Repeat step 2 around the egg, ending at **point c**. Sew through the first four 11°s added in this step.

**[5]** Work the remaining rows alternating between crystals and seed beads in the following bead counts. Go through the point bead to start the next row.

Row 5: 11°, 5mm bicone crystal, and 11°.

Row 6: Seven 11°s.

Row 7: 15°, 5mm bicone crystal, and 15°.



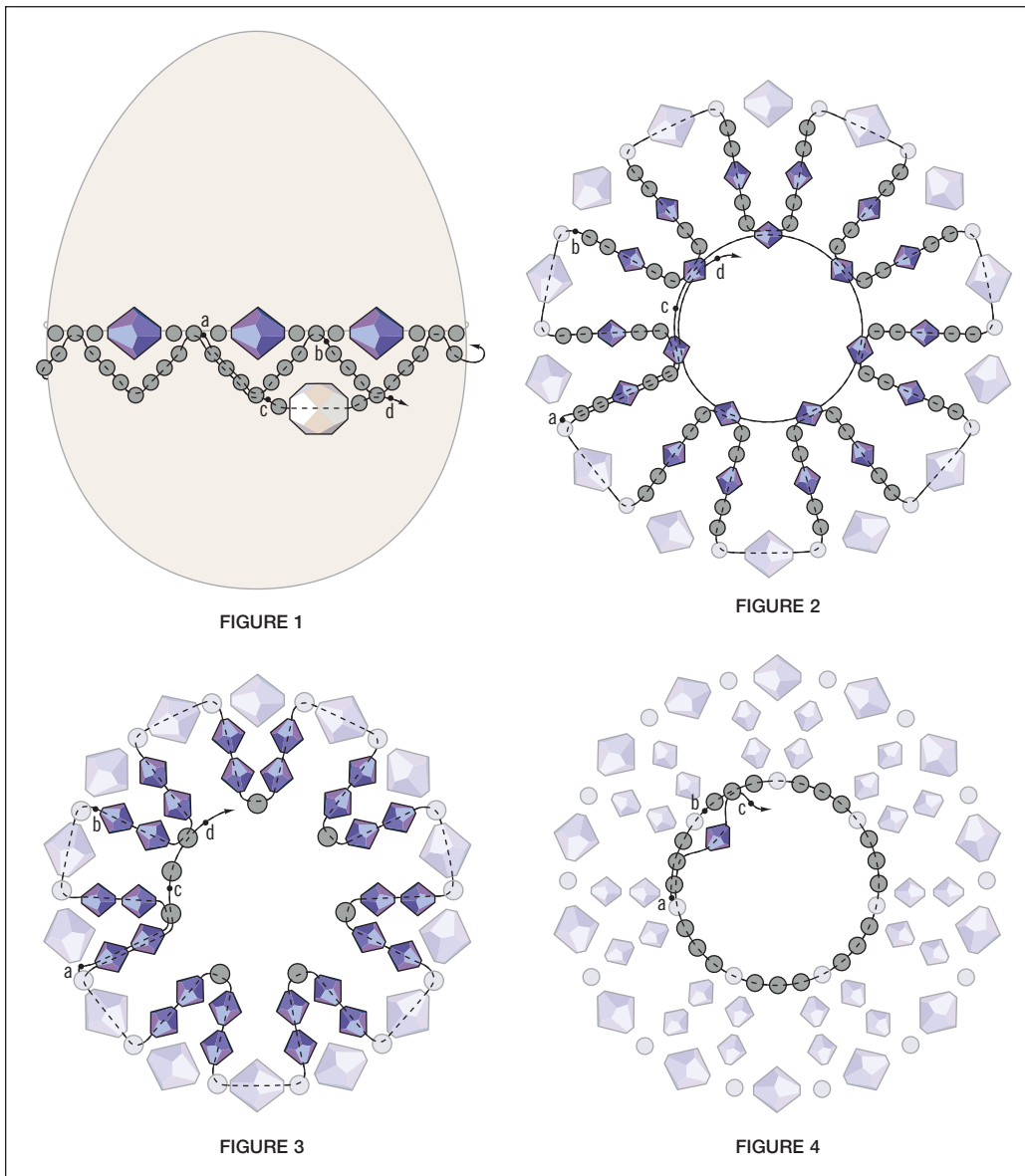

FIGURE 1

FIGURE 2

FIGURE 3

FIGURE 4

Row 8: Seven 11<sup>s</sup>.  
 Row 9: 15°, 4mm round crystal, and 15°.  
 Row 10: Seven 11<sup>s</sup>.  
 Row 11: 15°, 4mm bicone crystal, and 15°.  
 Row 12: Five 11<sup>s</sup>.  
 Row 13: 4mm bicone crystal.  
**[6]** Reinforce the last row of crystals with a second thread path and exit an 11°.  
**[7]** To close the bottom, pick up two 11<sup>s</sup>, a 3mm bicone, two 11<sup>s</sup>, a 3mm bicone, two 11<sup>s</sup>, a 3mm bicone, and two 11<sup>s</sup>. Sew through the next 11°, crystal, and 11 on the bottom row

(figure 2, a–b). Repeat six more times, then sew through the first six beads added in this step (a–c).  
**[8]** Sew through the next middle 3mm bicone (c–d). Repeat around the bottom of the egg, and reinforce with a second thread path. Secure the working thread with half-hitch knots (Basics) and trim.  
**[9]** Thread a needle on the tail. Refer to steps 2–5 and work the second half of the egg (rows 14–23) as you did rows 2–11. Then complete the remaining rows as follows:

Row 24: Seven 11<sup>s</sup>.  
 Row 25: 15°, 4mm bicone crystal, and 15°.  
 Row 26: Seven 11<sup>s</sup>.  
 Row 27: 15°, 3mm bicone crystal, and 15°.  
 Row 28: Five 11<sup>s</sup>.  
 Row 29: 3mm bicone crystal. Reinforce with a second thread path and exit an 11°.  
**[10]** To close the top, pick up two 3mm bicone crystals, an 11°, and two 3mm bicone crystals. Sew through the next 11°, crystal, and 11° on the top row (figure 3, a–b). Repeat six more times. Sew through the first three beads

## MATERIALS

### one egg

- wooden egg, 2½ in. (6.4cm)
- Japanese seed beads 30g size 11°  
10g size 15°
- Swarovski crystals  
14 6mm bicone  
56 5mm bicone  
56 4mm bicone  
28 4mm round  
70 3mm bicone
- 28 5-6mm (or smaller, optional) pearls, round or faceted, or 6mm round crystals
- Fireline 6 lb. test
- beading needles, #12
- acrylic paint (optional)

added in this step (b–c).  
**[11]** Close the top in one of two ways. Base your choice on the spacing of the beads in the previous step. Option 1: (The 11°s added in the previous step are close together at the top.) Pick up one 11° and sew through the next 11° from the previous step (c–d). Repeat around the egg. Option 2: (The 11°s added in the previous step are slightly spaced.) Pick up three 11°s and sew through the next 11° from the previous step (figure 4, a–b). Repeat around the egg and exit at point a. Sew through the first two 11°s added, pick up a 3mm bicone crystal, and sew through the next middle 11° (a–c). Repeat around the egg until back at point a.  
**[12]** Reinforce the last row with a second thread path, securing the tail with half-hitch knots. Trim the tail. ●

*Anna is an assistant editor at Bead&Button. For a 1-in. version of her egg, visit [beadandbutton.com](http://beadandbutton.com).*